

40 Aberdeen Avenue, Suite 006  
St. John's, NL  
A1A 5T3  
Phone: 709-800-4336  
E-mail: admin@ndal.com

## Road Closure – West Valley Road

Consumers, Residents and Businesses

As part of the ongoing Combined Sewer Separation Project, the City of Corner Brook wishes to advise residents and businesses of a temporary construction detour beginning on May 21, 2019, as part of the Phase 3 project.

West Valley Road between Elswick Road and Cobb Lane Extension (Work Zone #3) will be temporarily closed to allow for construction.

Motorists heading to West downtown are encouraged to take O'Connell Drive and Mount Bernard Avenue to bypass the construction completely.

Motorists and consumers wishing to access the West Street downtown area are asked to take the following route:

- If heading west on West Valley Road, motorists are advised to take Humber Park/Reid Street. Follow detour signage (refer to enclosed traffic plan).
- If heading east on Park Street, motorists are advised to take Central Street/Armstrong Avenue/Humber Park. Follow detour signage (refer to enclosed traffic plan).

Local traffic will be allowed to access West Valley Road during this detour. Please follow the direction of flags persons in the area.

The City of Corner Brook kindly asks motorists to obey all detour signage, reduce speeds and be respectful to fellow motorists and flags persons.

The City of Corner Brook would like to thank you for your cooperation and apologizes for any inconvenience this may cause. The public can visit the City's official website at [www.cornerbrook.com](http://www.cornerbrook.com) at any time to view up-to-date notices and advisories.

For further information regarding the project, please contact Jim Aylward at 709-800-4336 or Fred Taylor at 709-689-3478.

Kind Regards,

Jim Aylward, P.Eng.  
President  
Newfoundland Design Civil Limited

# City of Corner Brook Combined Sewer Separation Phase 3: Zone 3 - Traffic Detour Plan

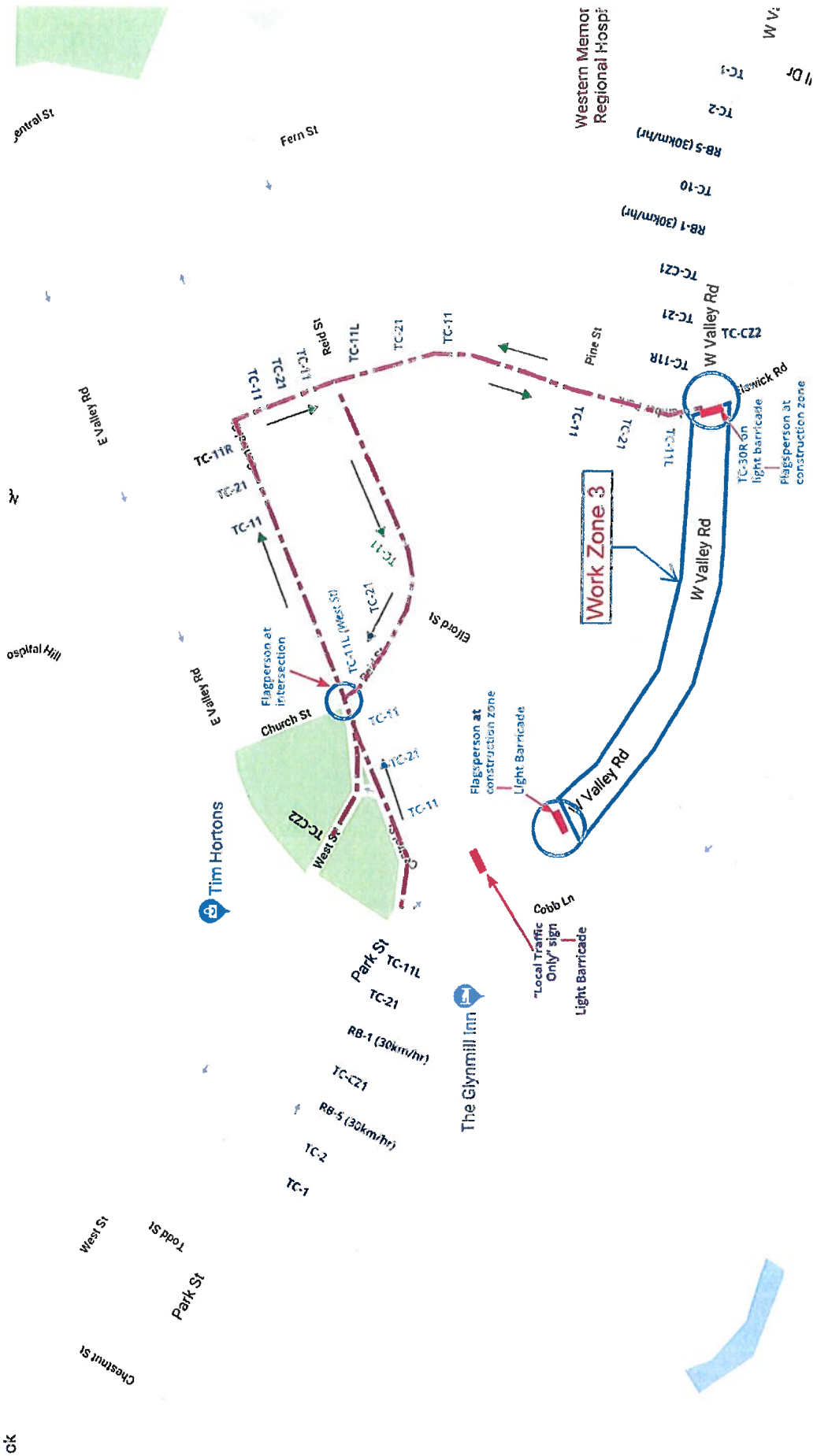

**Disclaimer:**  
Traffic/construction signage shown for general detour information only. All traffic control to conform to the latest edition of the City of Corner Brook Municipal Traffic Control Manual.

Distance between signs:  
50m (typ.), unless otherwise stated.

## Traffic Detour Route



# City of Corner Brook Combined Sewer Separation Phase 3: Downtown Traffic Detour Plan

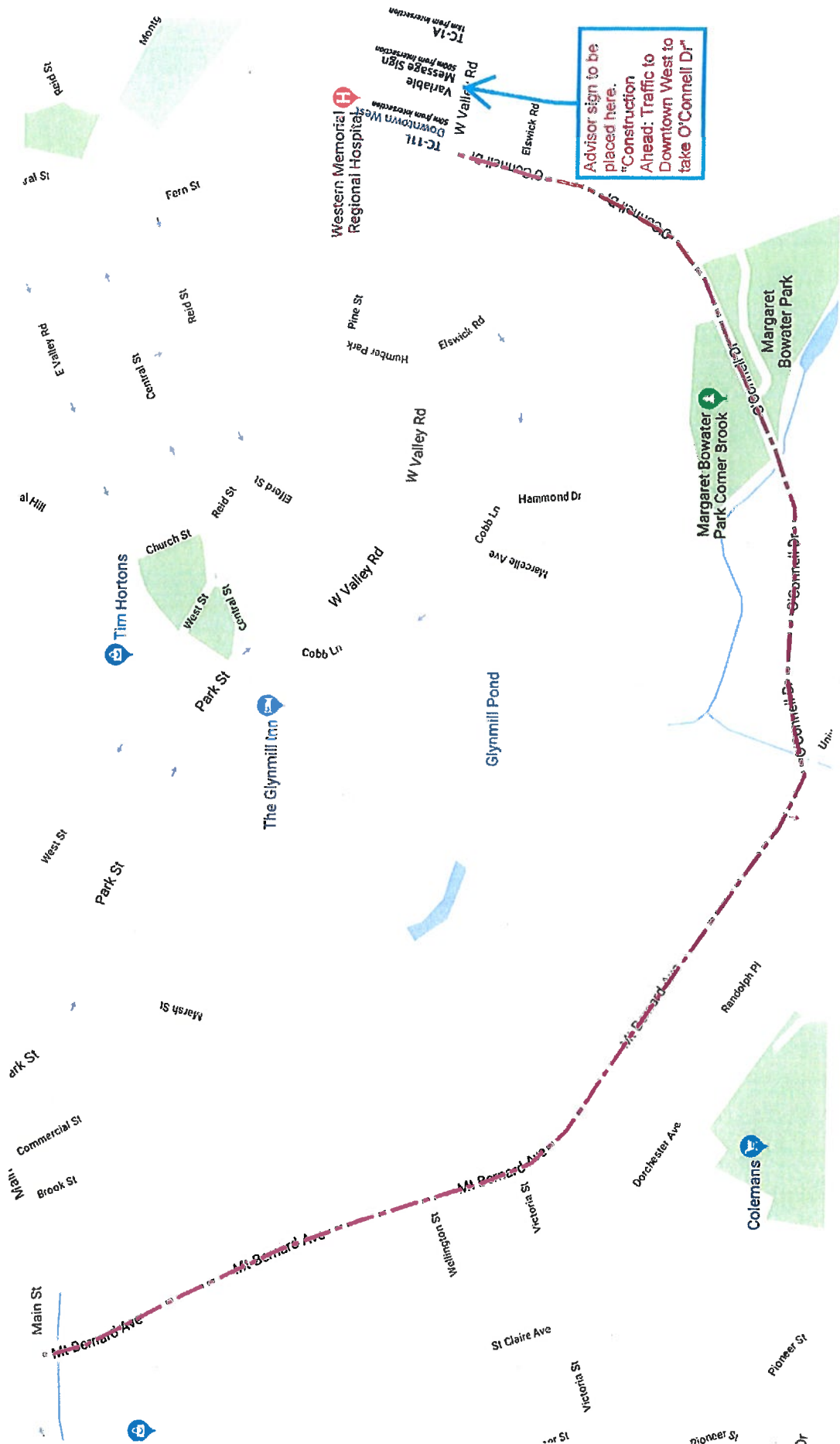

**Disclaimer:**  
Traffic/construction signage shown for general detour information only. All traffic control to conform to the latest edition of the City of Corner Brook Municipal Traffic Control Manual.

**Distance between signs:**  
50m (typ.), unless otherwise stated.

**Traffic Detour Route**