

### LEGEND

- SIGNAL HEAD
- PEDESTRIAN SIGNAL HEAD
- TRAFFIC CONTROLLER PAD
- POLE BASE
- SAWCUT
- PRE-FORMED
- JUNCTION BOX
- UNDERGROUND TRAFFIC SIGNAL CONDUIT
- UNDERGROUND TRAFFIC LOOP CONDUIT
- INDUCTIVE TRAFFIC LOOP
- UTILITY POLE
- OVERHEAD WIRE
- GUIDERAIL
- VIDEO DETECTION SYSTEM
- POLE MOUNTED CONTROLLER

### CONFIGURATIONS

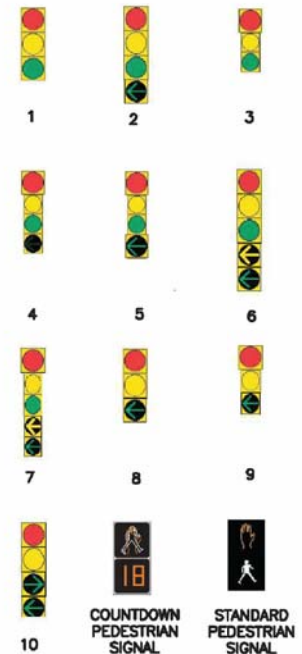

DETECTION INFORMATION		PREEMPTION INFORMATION	
TYPE	NONE	TYPE	NONE

**CITY OF CORNER BROOK**

**DRAWN BY:**  
SPECKER

**DATE:**  
10/22/2018

**SIGNALIZED INTERSECTIONS**  
WEST VALLEY ROAD/O'CONNELL DRIVE  
PAGE 7 OF 20

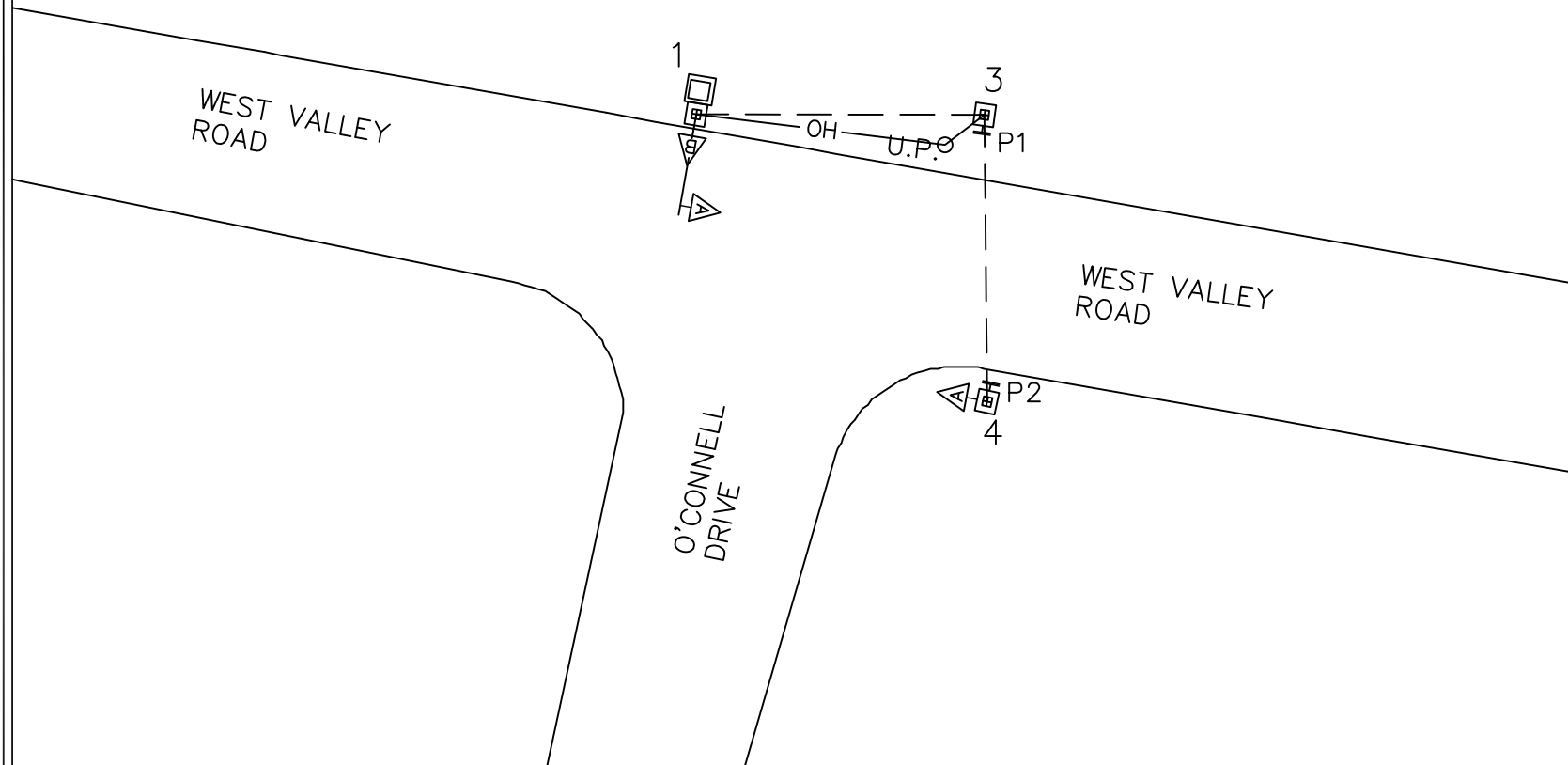

POLE NO.	TYPE	HEIGHT	REACH	DRAWING REFERENCE	TYPE	CONFIGURATION	MOUNTING HEIGHT	OFFSET FROM POLE	MOUNTING HARDWARE	DRAWING REFERENCE	CONFIGURATION	MOUNTING HEIGHT	MOUNTING HARDWARE	# OF PUSHBUTTONS	CONTROLS CROSSWALK DIRECTION	TYPE
1	MAST ARM	6.5m	4.5m	A	PRIMARY	2	6.5m	4.5m	SPRING CUSHION HANGER	-	-	-	-	-	-	-
2	UTILITY POLE	-	-	B	PRIMARY	10	4.5m	-	VERTICAL PIPE BRACKET	-	-	-	-	-	-	-
3	PEDESTAL	3.0m	-	-	-	-	-	-	-	-	-	-	-	1	N-S	MECHANICAL
4	PEDESTAL	6.5m	-	-	PRIMARY	1	4.5m	-	VERTICAL PIPE BRACKET	P2	COUNTDOWN	2.5m	VERTICAL PIPE BRACKET	1	N-S	MECHANICAL

NOTE: THE LOCATION OF THE OF THE UNDERGROUND CONDUIT SHOWN ON THE DRAWING IS APPROXIMATE

SCALE  
N.T.S.